

# EMERGENCY INFORMATION

For **EMERGENCY** or  
**FIRST AID** assistance  
phone ext. **7777**  
or **4350 2222**

## IN AN EVACUATION

### When an **ALARM SOUNDS**

- Follow warden instructions
- Do not use lifts
- Leave via nearest emergency exit
- Move away from the building
- Go to assembly area

### IF UNSAFE OUTSIDE

- Stay in your classroom
- Follow warden instructions
- Close the windows, blinds & doors,  
& move to the centre of the room
- Remain where you are until told to  
move or leave by a warden

## Wyong Campus

**TEACHERS** - In an emergency you **MUST** ensure that your students are kept together - **NOTIFY** warden if any students are missing

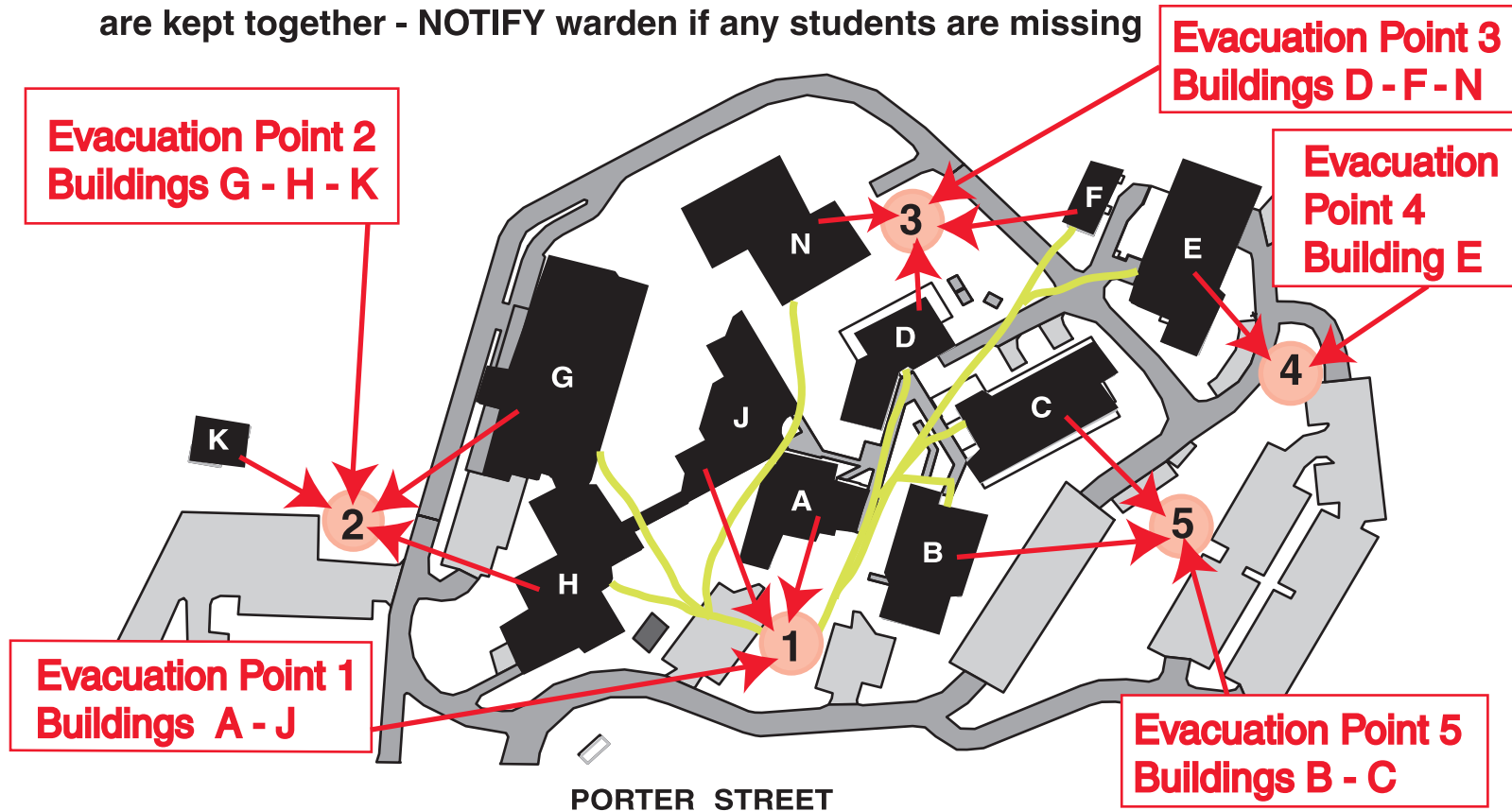

**▶ PLEASE REPORT ANY SUSPICIOUS ACTIVITY OR BEHAVIOUR  
TO CAMPUS SECURITY ON: 4350 2285**

 Alternate route for people with mobility difficulties